

# SITE PLAN

The overall organization of the park is to be an "Eddy Art Park", tying the natural resource of Emigration Creek and the soul of the property in the art pieces. The major move behind this concept plan is to minimize vehicular access into the site from 1300 East, terminating vehicular circulation at the Allen Residence. The house itself is to be used as a "Visitor Center" of sorts, retaining the primary two story volume, but turning the northeast wing into an outdoor patio for events and gathering space.

This concept proposes 11 "Eddies" as a means to create identifiable gathering spaces along the creek corridor. A "Garden Promenade" acts as the main pedestrian circulation and organizational pattern to highlight existing features, as well as create new garden experiences. The four-plex has an opportunity to be refurbished as an event venue.

Light posts are also to be refurbished and, along with the concrete mosaics and existing art pieces, distributed among the eddies, trails and gathering spaces. This concept will use the low, stone and

concrete walls that currently adorn many of the buildings along the property as a design element that not only acts as a nod toward this historic design, but will also help visitors immediately identify the eddies.



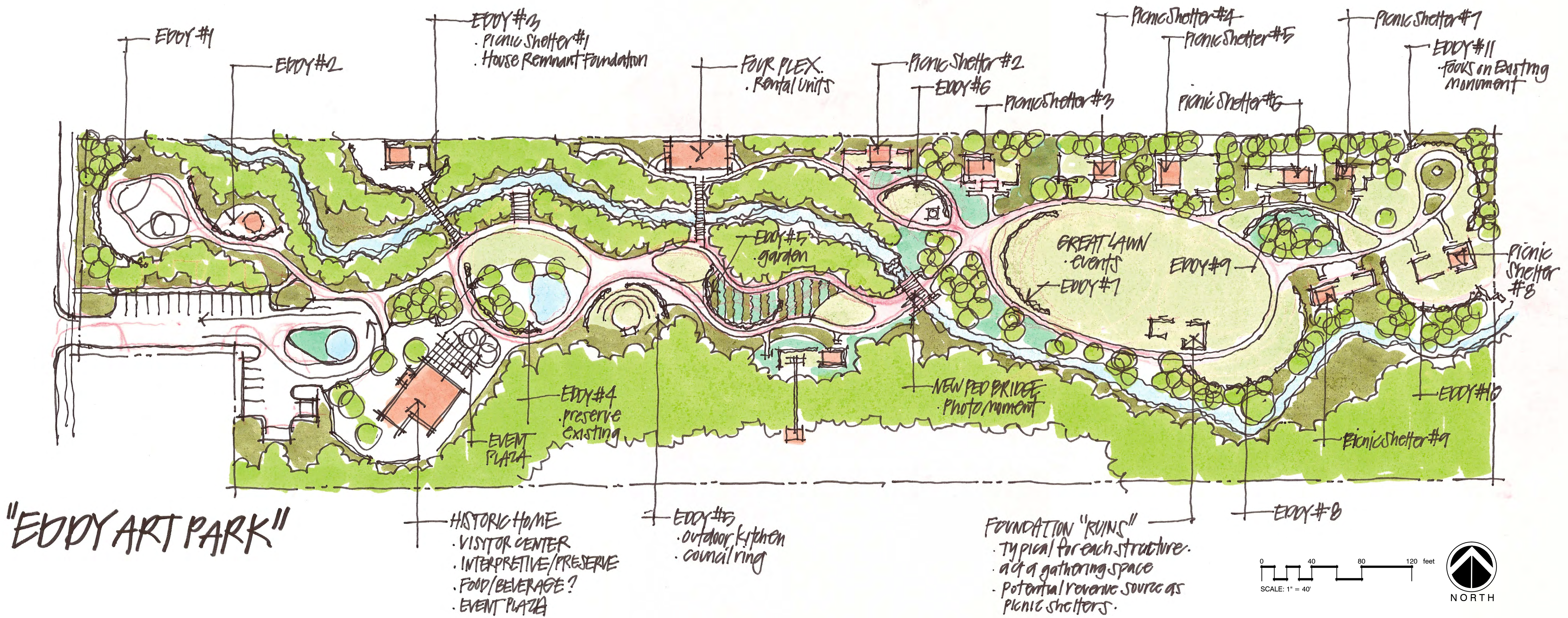

This design also celebrates a "Great Lawn" which is to offer space for large events such as weddings, family reunions, concerts, and educational experiences, which could be particularly beneficial to Westminster College. This design is to both act as a traditional park, as well as celebrate the ethos of this place and honor the Allen's legacy.

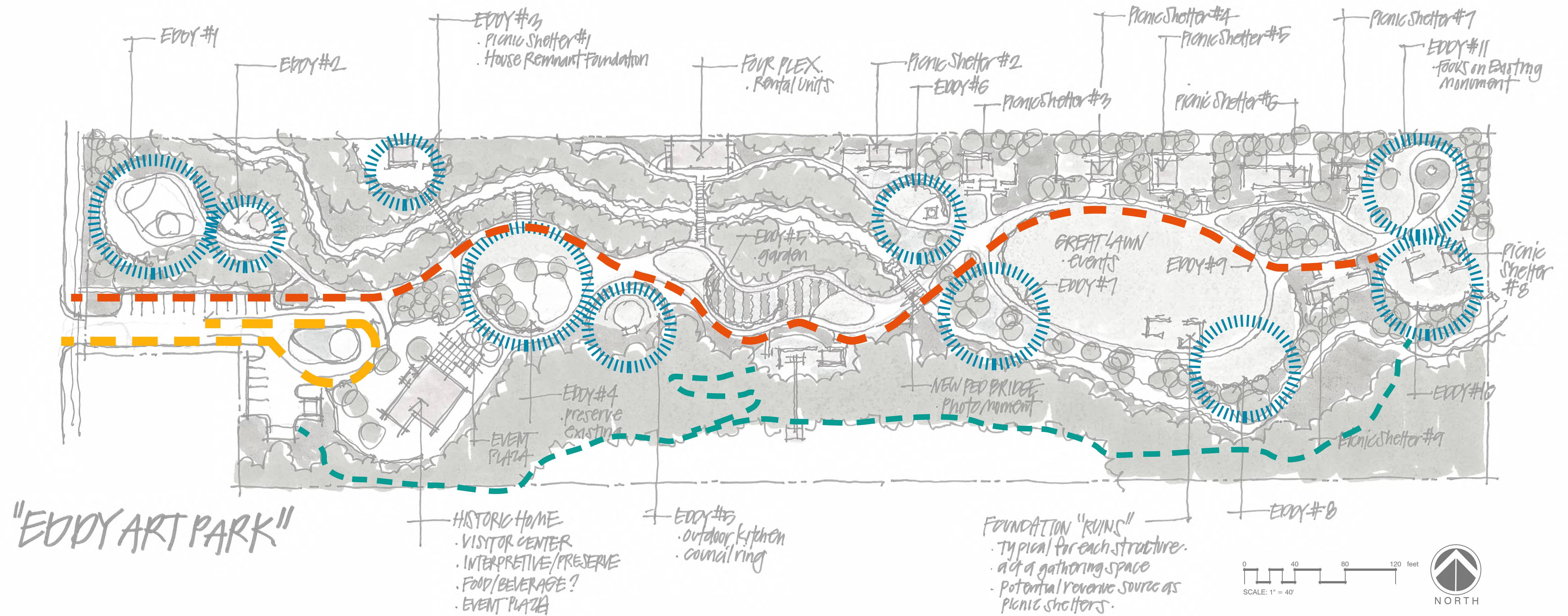

# CIRCULATION DIAGRAM

With the Garden Promenade as the main pedestrian route through the park, the eddies offer spaces to linger and engage with other visitors for picnics, events, and respite. In dispersing these across the site, they form recognizable spaces to explore and find historic art pieces. Finally, nature trails lead visitors through a more wooded, natural landscape, leading them to a high point on the property.



-  GARDEN PROMENADE
-  NATURE TRAILS
-  VEHICULAR CIRCULATION
-  EDDIES

# GREEN SPACE/ CREEK/ WILDLIFE

The plantings are to be in keeping with what currently exists on site, with the addition of an understory progression planting strategy. Within the site's seven plus acres, there is space to carve out areas as habitat by minimizing visitor access as a way to reduce human disturbance. Care will also be taken to create a peacock sanctuary with thoughtful planting arrangements and features to support their life-cycle needs.

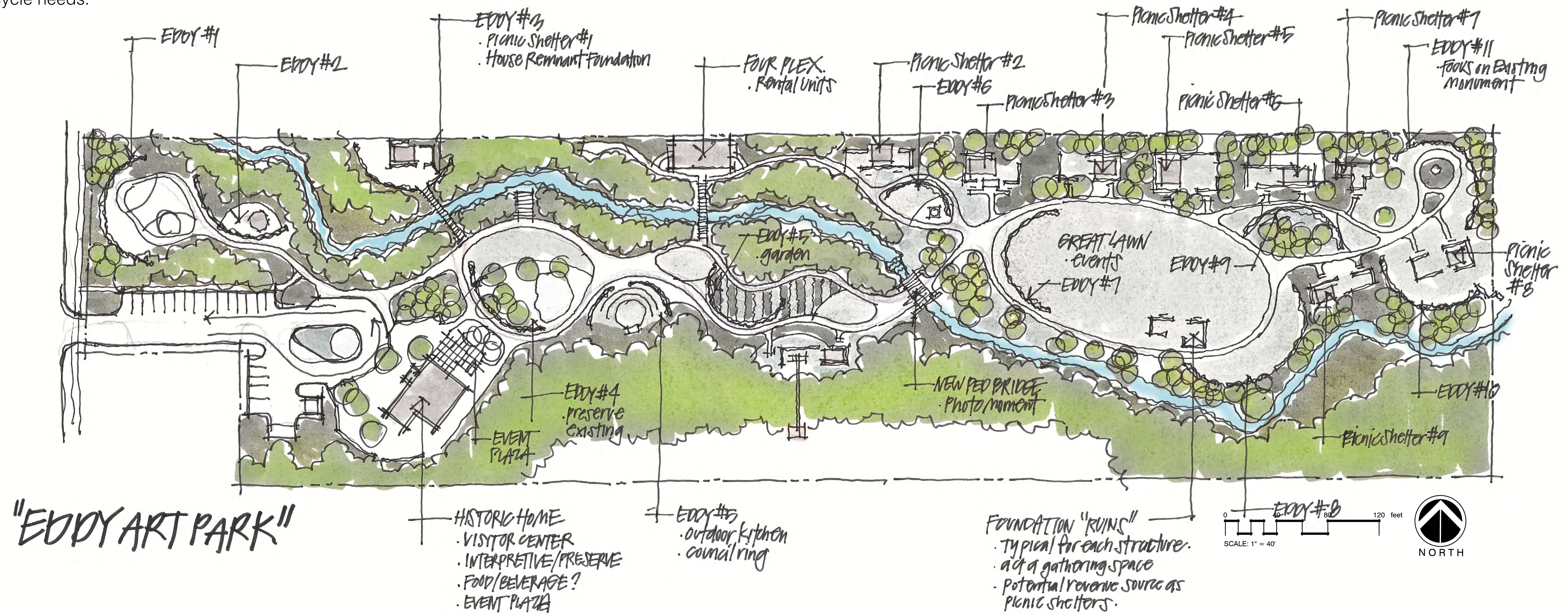

Vegetation throughout helps to hide and reveal art pieces



Ornamental species in front of the Allen Residence

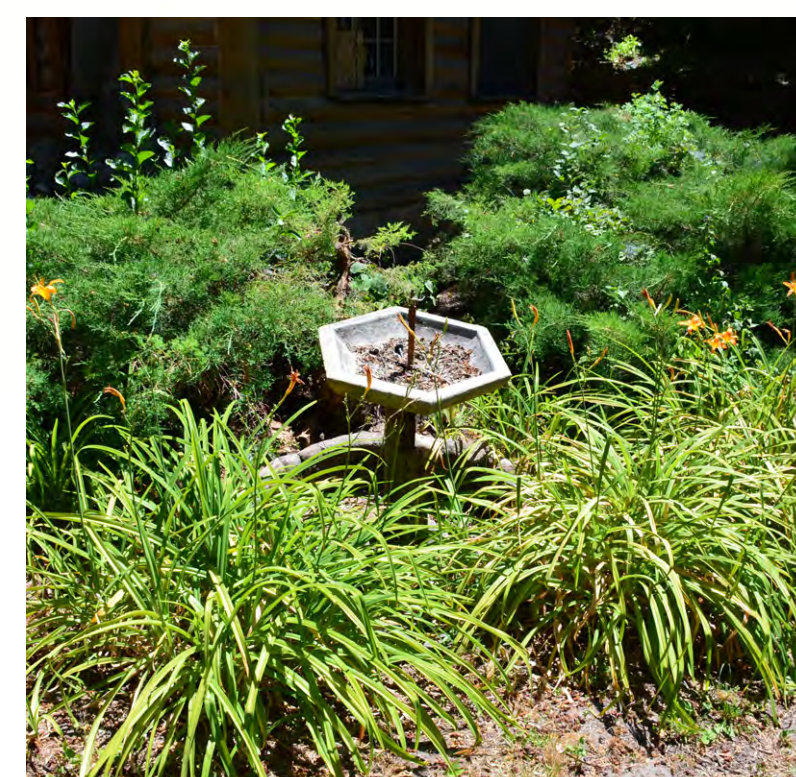

Day Lily and Juniper in front of the Allen Residence

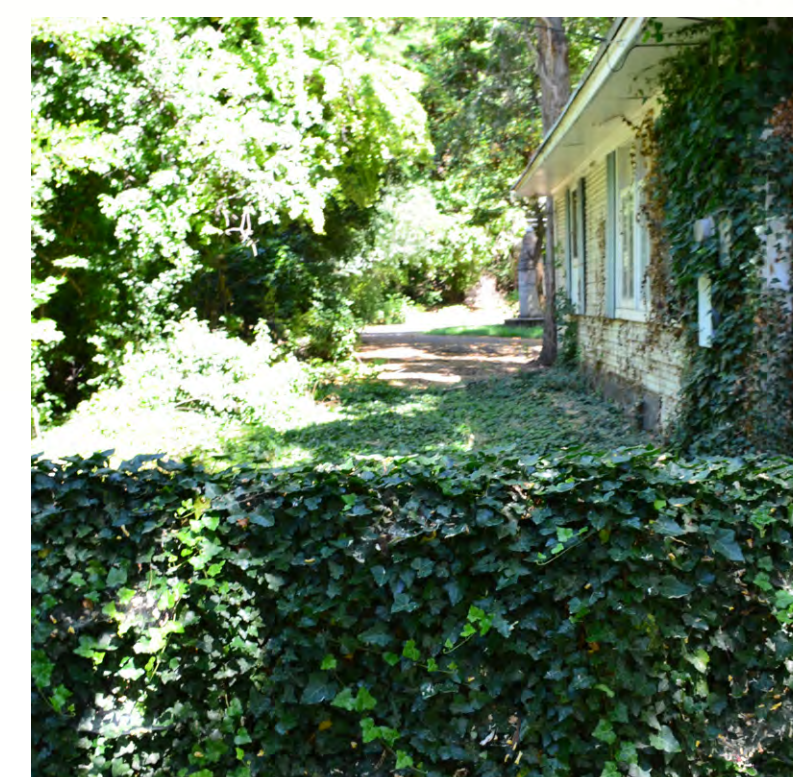

Invasive English Ivy at one of the residences



A mature tree canopy shades much of the park

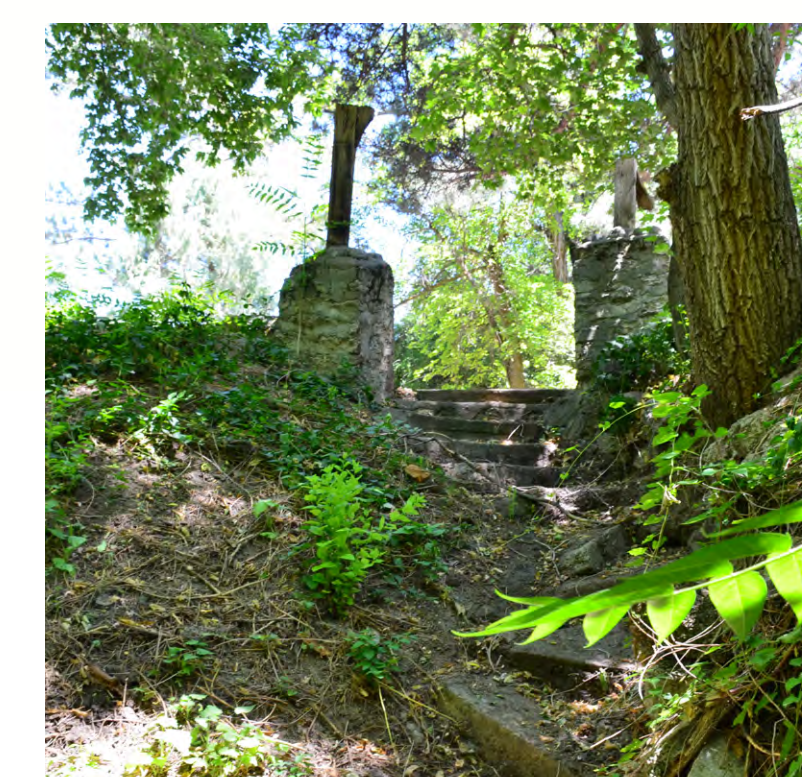

Riparian plantings conceal small foot paths to Emigration Creek

# PERSPECTIVE 1 - PICNIC EDDY

The Picnic Eddy perspective highlights the opportunity to use existing site features as a means to delineate gathering spaces. In this case, those features are the existing brick gazebo, lamp post, concrete mosaics, stone benches, sculpture pieces, and stone walls. Additionally, this concept proposes the incorporation of bird houses to honor Dr. Allen's love of avian species. These could also be a way in which to engage the community as a donated piece of art from a group or organization. Finally, there will be a designated space for peacock habitat within Eddy 1.

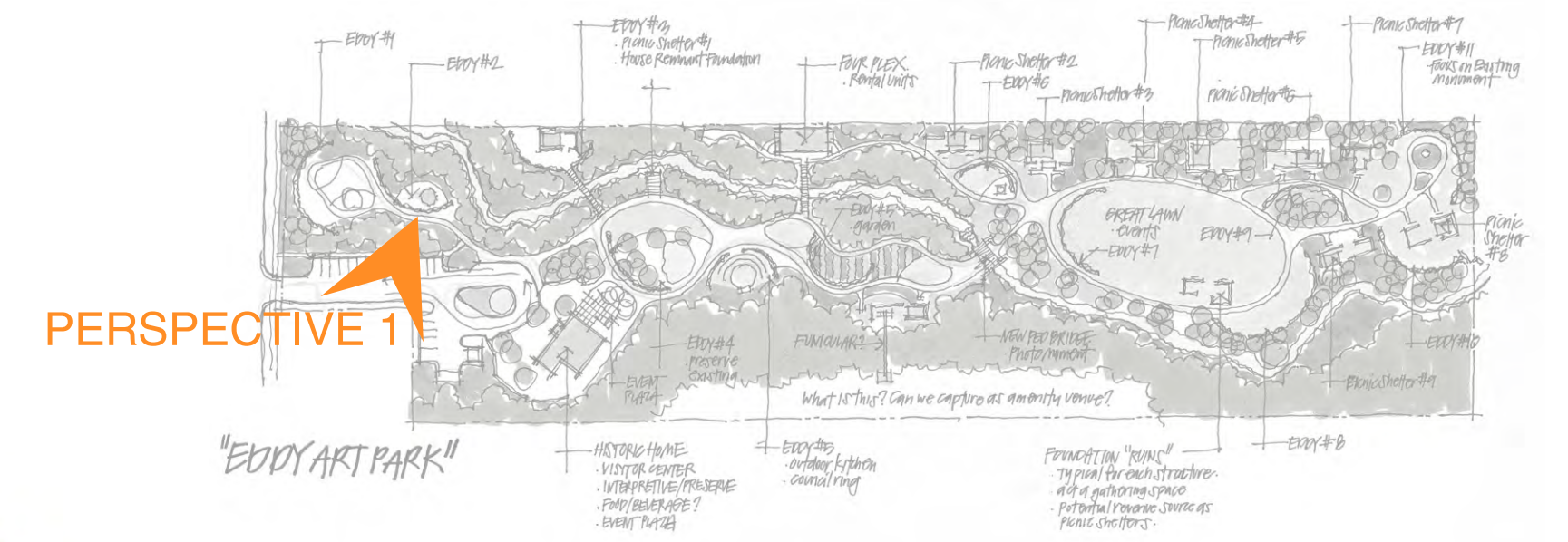

Peacock currently living on site



One of 19 concrete mosaic art pieces found on site



Stone bench



Stone and concrete lamp post



Brick gazebo



Bird cage

# PERSPECTIVE 2 - CENTRAL GATHERING

The Central Gathering Lawn also folds in existing site features, while offering picnic pads and looping walking paths. The creek cuts through this section of the site with steep banks and a bridge to access nature paths that ascend to the south portion of the site. An existing platform has the opportunity feature an art sculpture, commissioned by a local artist to be on display for a period of time.

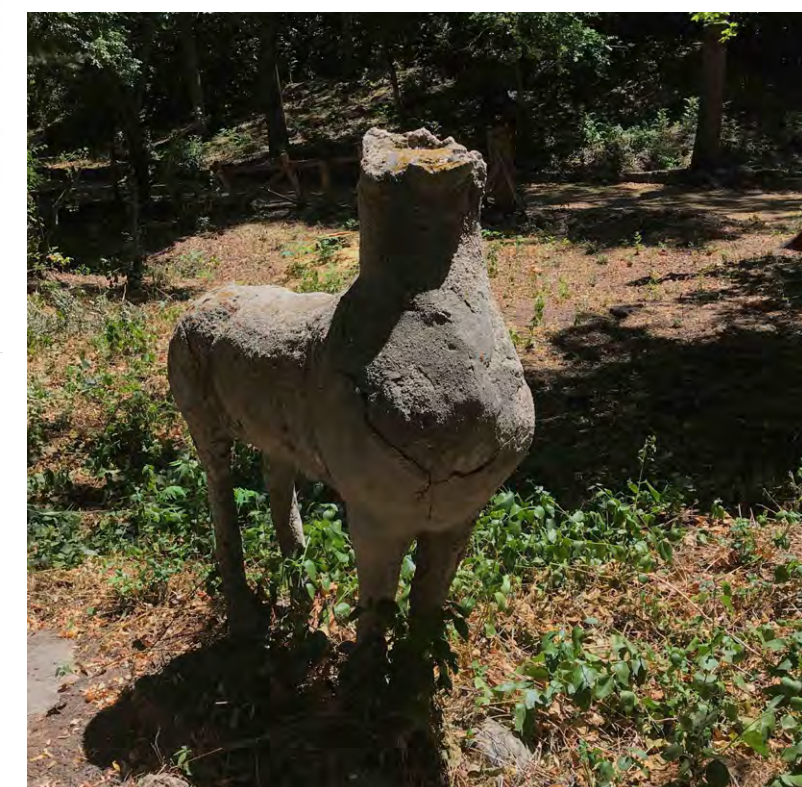
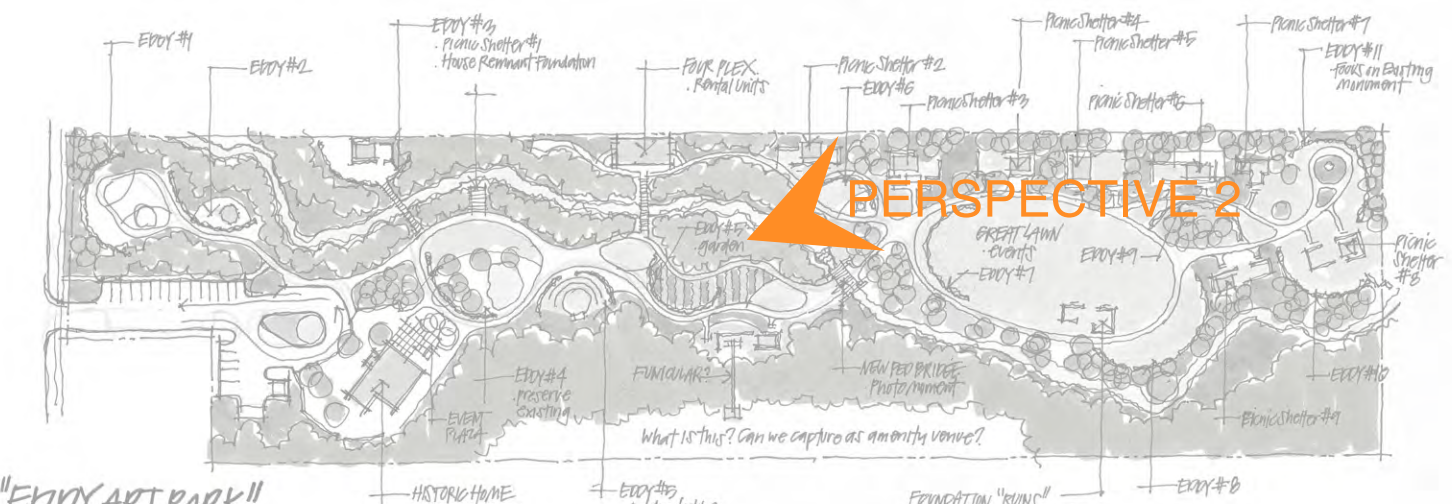

Existing sculptural elements found on site



Stone wall on site



Existing concrete and stone platform



Mosaic on light post

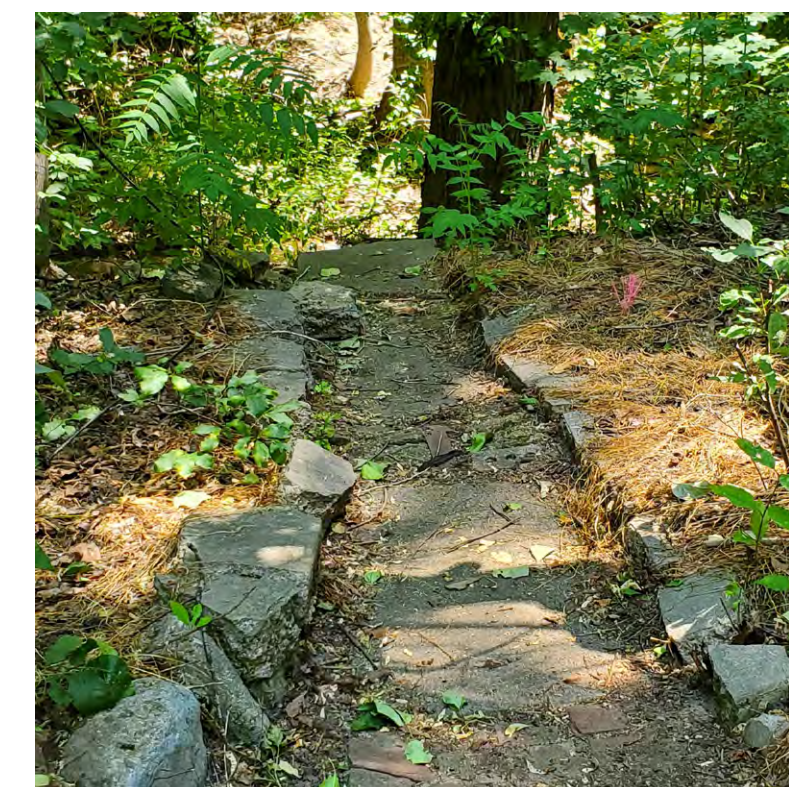

Existing nature path



Concrete orb

# PERSPECTIVE 3 - THE GREAT LAWN

As with the first perspective, The Great Lawn folds in existing site features, while also creating gathering spaces for large and small groups. Around the perimeter, the City will explore re-purposing existing buildings. In this design concept, they could be re-used as picnic pad locations. Visible are also the well, lamp post, walls, and day-lit Emigration Creek. In opening the creek corridor, it creates an opportunity to bring the audio-visual experience of being near water to visitors, where they can enjoy the experience from a bridge constructed in a similar fashion to the existing bridge leading to the four-plex.

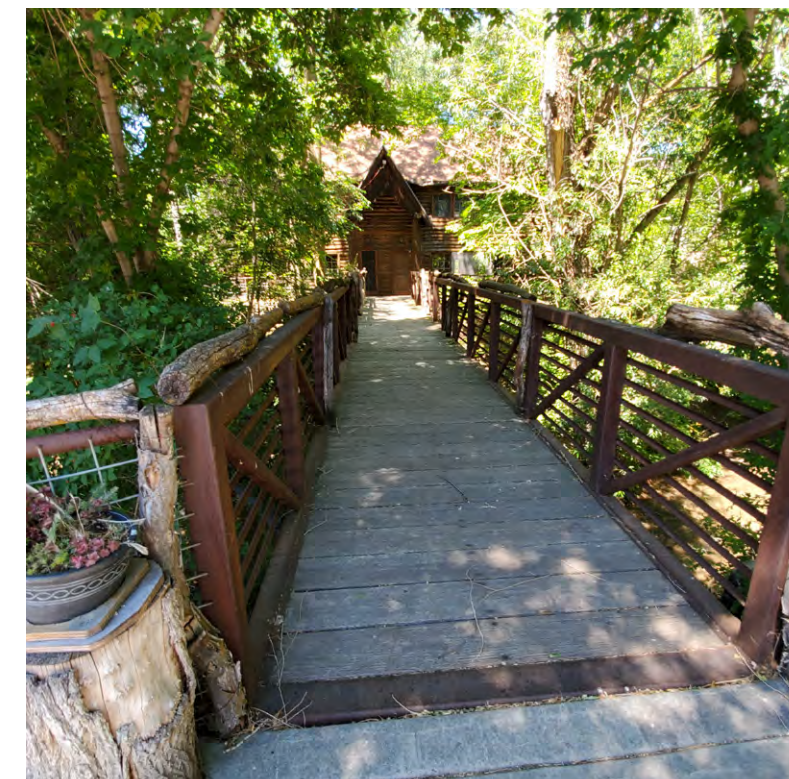
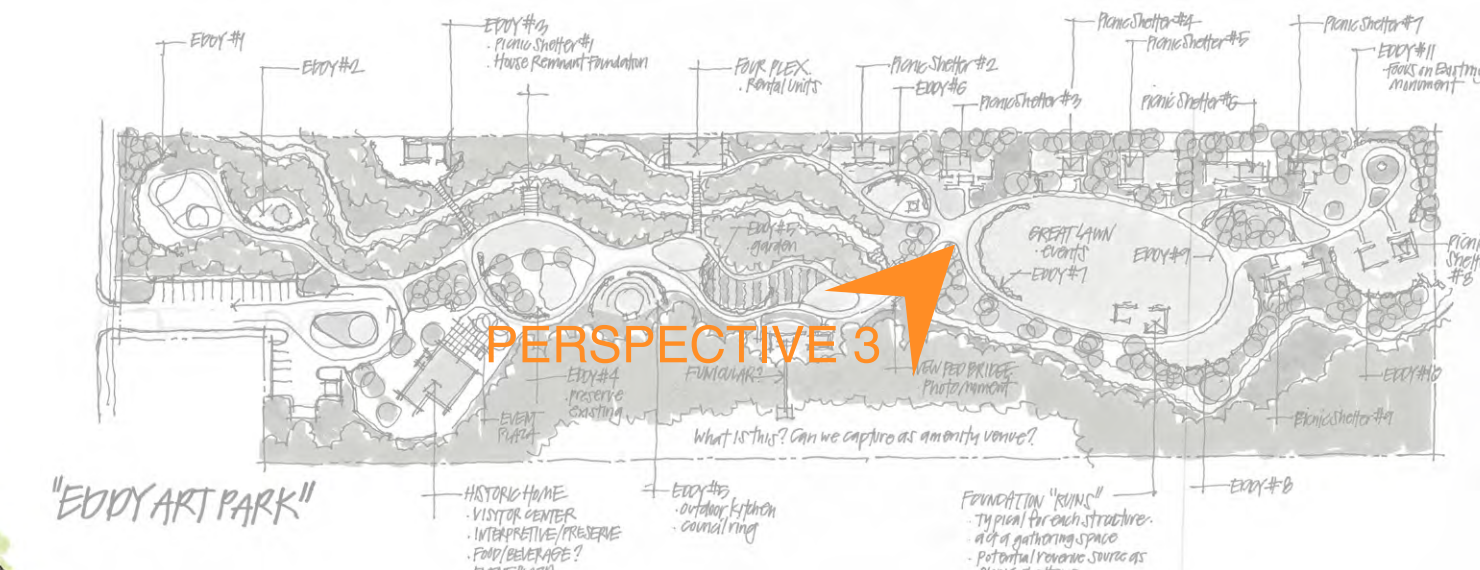
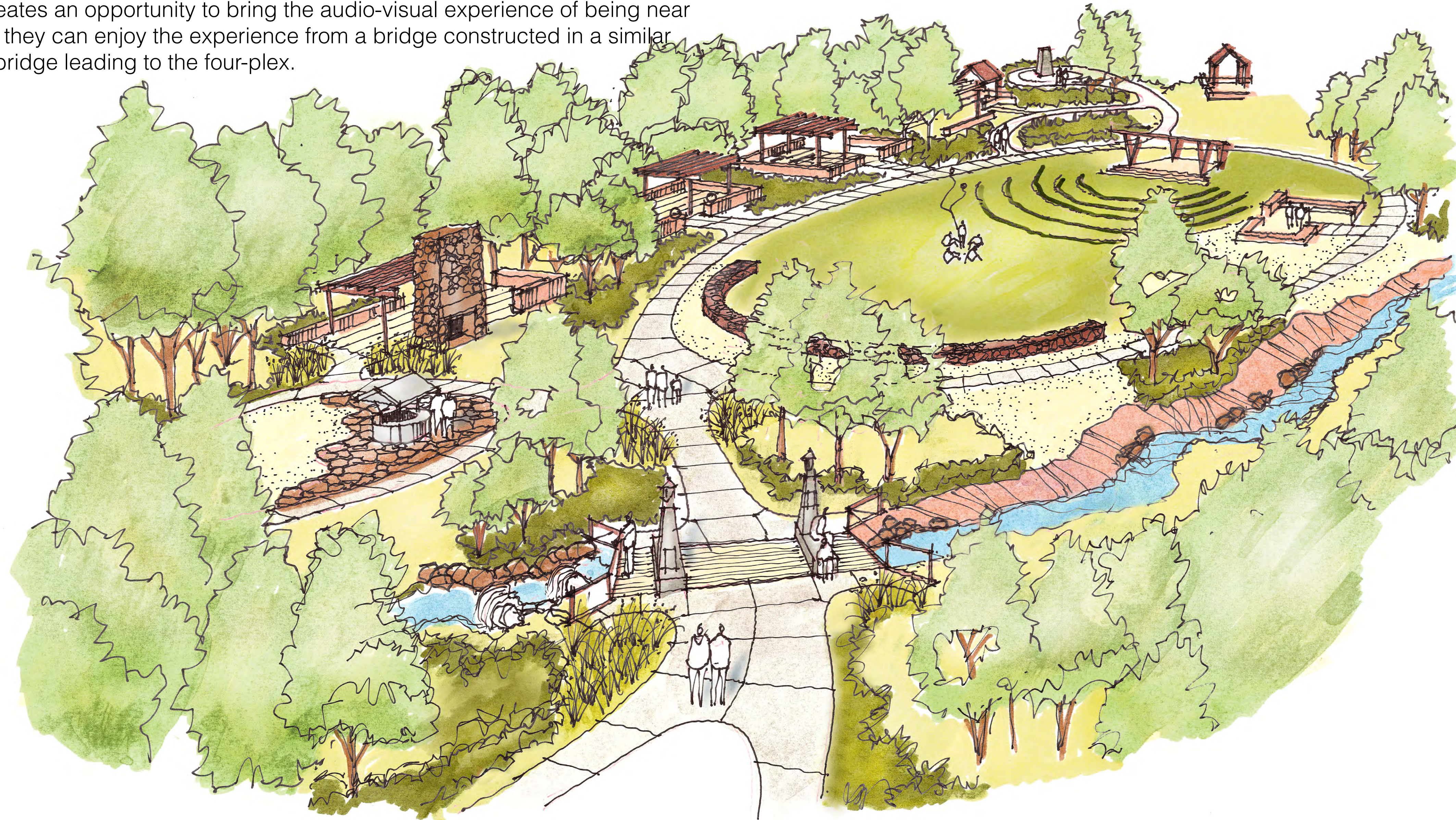

Four-plex bridge



Residence



Water well



Stone and concrete lamp post



Mary Rose fire place



Emigration Creek